

AGM2E 100 L 6

IE2

GAMAK

3-Phase 230/400 V 50 Hz

- Duty Type : S1
- Degree of protection : IP 55 (TEFC)
- Insulation class : F (155 °C)
- Temp rise : Class B (80K)
- Mounting Design : B3

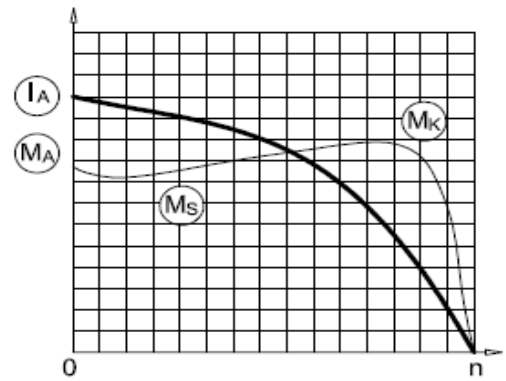

ELECTRICAL DESIGN

Direct On Line

Rated output (kW) : 1.5	Locked rotor Current – Ia (A) : 16
	Ia / In : 4.5
Speed (rpm) : 945	Locked rotor Torque – Ma (Nm) : 33
	Ma / Mn : 2.2

Rated current (A) : 3.6

Y / Δ Starting

Torque – Mn (Nm) : 15.2	Locked rotor Current – Ia (A) : -						
	Ia / In : -						
Cos φ : 0.75	Locked rotor Torque – Ma (Nm) : -						
	Ma / Mn : -						
Efficiency % : <table border="1" style="display: inline-table; vertical-align: middle;"> <tr> <td>4/4</td> <td>3/4</td> <td>1/2</td> </tr> <tr> <td>79.8</td> <td>79.7</td> <td>76.4</td> </tr> </table>	4/4	3/4	1/2	79.8	79.7	76.4	Breakdown Torque – Mk (Nm) : 36
4/4	3/4	1/2					
79.8	79.7	76.4					
	Mk / Mn : 2.4						

Moment of inertia J (kgm)² : 0.0077

MECHANICAL DESIGN

- Frame : Aluminium
- End shields : Aluminium
- Cooling fan : Plastic
- Terminal box : Plastic
- Cable gland : Pg 16
- No of cable glands : 2

Bearing Arrangement

	Drive End	Non Drive End
Standard design	6206 ZZ	6206 ZZ
Reinforced design	-	-
Noise Level (dB-A) : 50		
Paint : RAL 7031- Grey		
Approximate weight (kg) : 19.1		

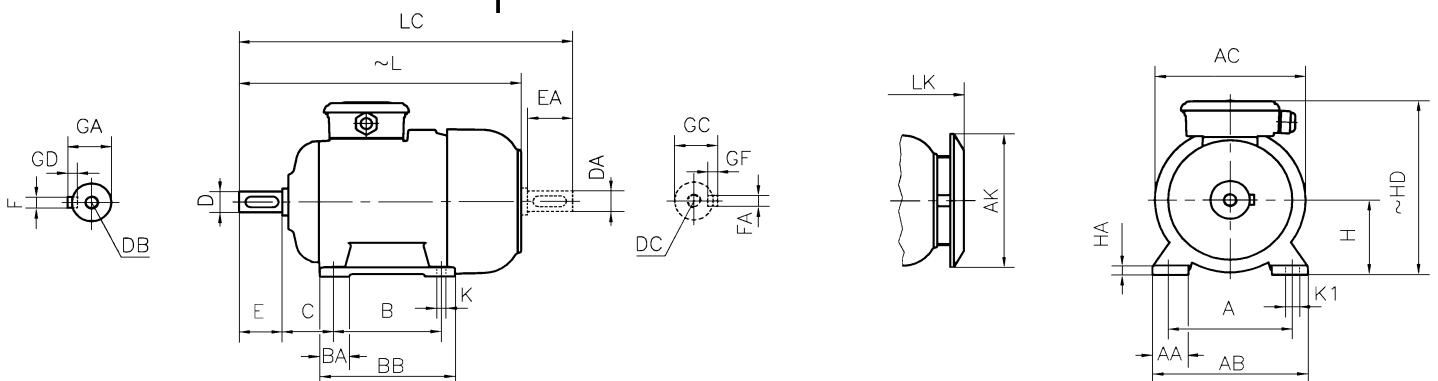

DIMENSIONS

Dimensions of foot mounted motors for mounting arrangement : B3, B6, B7, B8, B15, V5, V6																							
H	HD ~	HA	A	AA	AB	ØAC	ØAK	K	K1	B	B'	BA	BA'	BB	L ~	LC	LK ~	C	E EA	DB DC	ØD ØDA	GA GC	FxGD FAXGF
100	234	13	160	47	200	194	189	12	18	140	-	39	-	175	376	442	413	63	60	M10	28	31	8X7

* Efficiencies are calculated according to indirect method where the additional load losses are determined from exact measurements at different load points.